

Aluminum 1-Way Hanger Assemblies

Pelco's Span Wire mountings are available in aluminum or iron with 1-1/2" NPS or tri-stud fittings. Balance adjusters provide additional adjustment capabilities, while tether assemblies may be used to anchor the bottom of signals in windy applications.

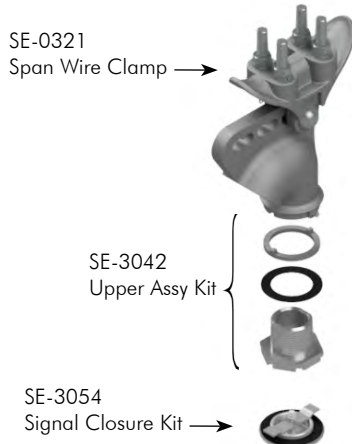
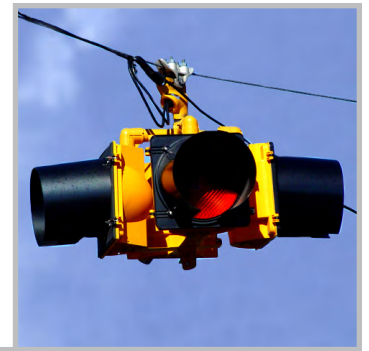

Span Wire Hanger Assy, Alum Cast Nipple

	Bushing		Stainless Upgrade		Coating
SE-3043 -	<input type="checkbox"/>	-	<input type="checkbox"/>	-	<input type="checkbox"/>
	Blank=None SB=Stainless Bushing		Blank=Galv SS=Stainless		PNC=Process No Color P__=Paint

Note:
Stainless upgrade includes stainless steel fasteners and pins on span wire clamp.

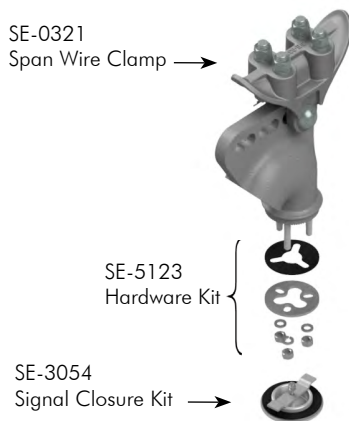

Span Wire Hanger Assy, Alum Tri-Stud

	Bushing		Stainless Upgrade		Coating
SE-5089 -	<input type="checkbox"/>	-	<input type="checkbox"/>	-	<input type="checkbox"/>
	Blank=None SB=Stainless Bushing		Blank=Galv SS=Stainless		PNC=Process No Color P__=Paint

Note:
Stainless upgrade includes stainless steel fasteners and pins on span wire clamp.



Span Wire Hanger Assy, Alum w/ Iron Balance Adjuster Cast Nipple

	Bushing		Stainless Upgrade		Coating
SE-3033 -	<input type="checkbox"/>	-	<input type="checkbox"/>	-	<input type="checkbox"/>
	Blank=None Sb=Stainless Bushing		Blank=Galv SS=Stainless		PNC=Process No Color P__=Paint

Note:
Stainless upgrade includes stainless steel fasteners and pins on span wire clamp.

Note: 1. All assemblies are supplied standard with stainless slotted washer and fasteners, with galvanized hardware on span wire clamps. Stainless upgrade available.
2. See Reference Section page v for available paint colors.

Aluminum 1-Way Hanger Assemblies

Pelco's Span Wire mountings are available in aluminum or iron with 1-1/2" NPS or tri-stud fittings. Balance adjusters provide additional adjustment capabilities, while tether assemblies may be used to anchor the bottom of signals in windy applications.

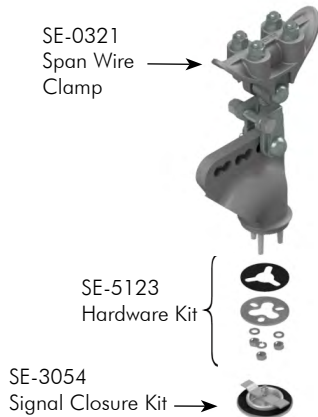
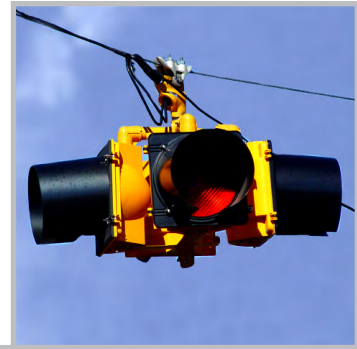

Span Wire Hanger Assy w/ Iron Balance Adjuster Tri-Stud, Alum

SE-5162 - - -

Bushing	Stainless Upgrade	Coating
Blank=None SB=Stainless Bushing	Blank=Galv SS=Stainless	PNC=Process No Color P__=Paint

Note:
Stainless upgrade includes stainless steel fasteners and pins on span wire clamp.

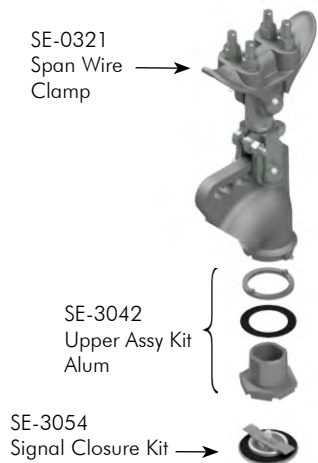

Span Wire Hanger Assy w/ PAL Balance Adjuster Cast Nipple, Alum

SE-3276 - - -

Bushing	Stainless Upgrade	Coating
Blank=None SB=Stainless Bushing	Blank=Galv SS=Stainless	PNC=Process No Color P__=Paint

Note:
Stainless upgrade includes stainless steel fasteners and pins on span wire clamp.

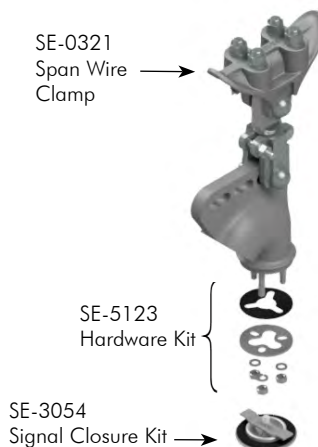

Span Wire Hanger Assy w/ PAL Balance Adjuster Tri-Stud, Alum

SE-5164 - - -

Bushing	Stainless Upgrade	Coating
Blank=None SB=Stainless Bushing	Blank=Galv SS=Stainless	PNC=Process No Color P__=Paint

Note:
Stainless upgrade includes stainless steel fasteners and pins on span wire clamp.

Note: 1. All assemblies are supplied standard with stainless slotted washer and fasteners, with galvanized hardware on span wire clamps. Stainless upgrade available.
2. See Reference Section page v for available paint colors.



FREE-SWINGING



Aluminum 1-Way Hanger Assemblies Tri-Stud

Pelco's Span Wire mountings are available in aluminum or iron with 1-1/2" NPS or tri-stud fittings. Balance adjusters provide additional adjustment capabilities, while tether assemblies may be used to anchor the bottom of signals in windy applications.

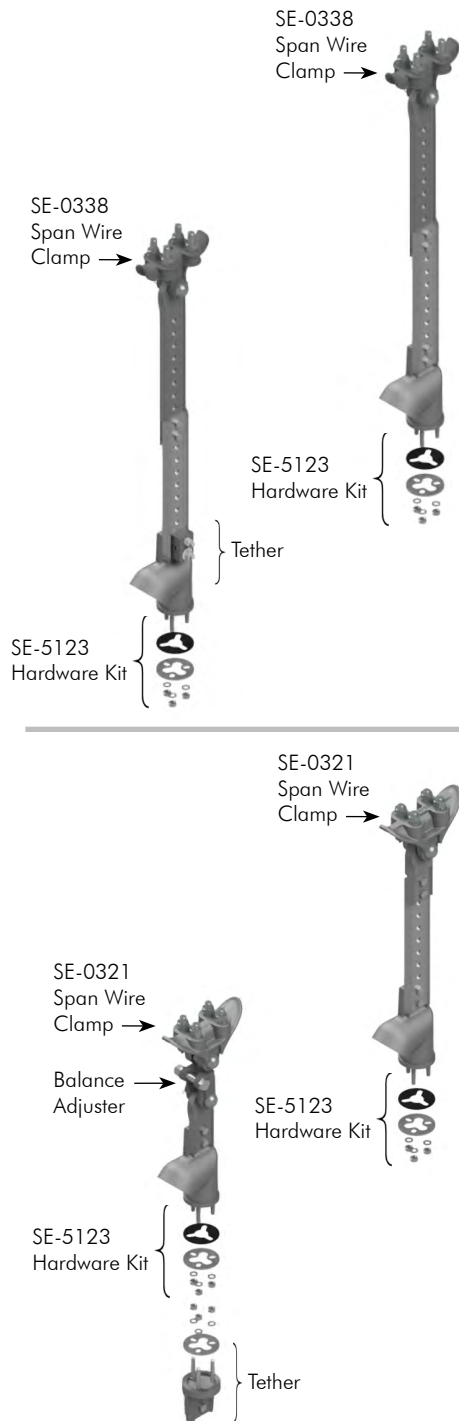
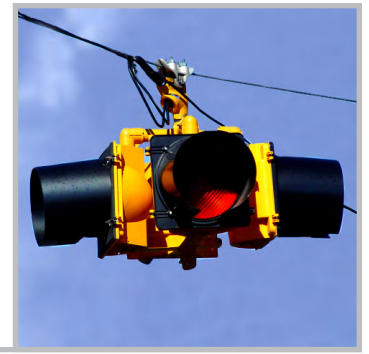

Span Wire Hanger Assy w/ Iron Span Wire Clamp, Tri-Stud & Adjustable Extender, Alum

SE-5072	Extender	Stainless Upgrade	Coating
	<input type="checkbox"/>	<input type="checkbox"/>	<input type="checkbox"/>
	06=6" Length	Blank=Galv	PNC=Process No Color
	11=11" Length	SS=Stainless	P__=Paint
	19=19" Length		
	40=40" Length		
	48=48" Length		
	72=72" Length		

Note:
Stainless upgrade includes stainless steel fasteners and pins on span wire clamp.

Span Wire Hanger Assy w/ Iron Span Wire Clamp, Tri-Stud, Adjustable Extender & Tether, Alum

SE-5024	Extender	Stainless Upgrade	Coating
	<input type="checkbox"/>	<input type="checkbox"/>	<input type="checkbox"/>
	06=6" Length	Blank=Galv	PNC=Process No Color
	11=11" Length	SS=Stainless	P__=Paint
	19=19" Length		
	40=40" Length		
	48=48" Length		
	72=72" Length		

Note:
Stainless upgrade includes stainless steel fasteners and pins on span wire clamp.

Span Wire Hanger Assy w/ Alum Span Wire Clamp, Tri-Stud, Alum

SE-5196	Extender	Bushing	Stainless Upgrade	Coating
	<input type="checkbox"/>	<input type="checkbox"/>	<input type="checkbox"/>	<input type="checkbox"/>
	06=6" Length	Blank=None	Blank=Galv	PNC=Process No Color
	11=11" Length	SB=Stainless	SS=Stainless	P__=Paint
	19=19" Length	Bushing		
	40=40" Length			
	48=48" Length			
	72=72" Length			

Note:
Stainless upgrade includes stainless steel fasteners and pins on span wire clamp.

Span Wire Hanger Assy w/ Alum Span Wire Clamp, Tri-Stud, Iron Balance Adjuster & Tether, Alum

SE-5073	Bushing	Stainless Upgrade	Coating
	<input type="checkbox"/>	<input type="checkbox"/>	<input type="checkbox"/>
	Blank=None	Blank=Galv	PNC=Process No Color
	SB=Stainless	SS=Stainless	P__=Paint
	Bushing		



Note:
Stainless upgrade includes stainless steel fasteners and pins on span wire clamp.

Note: 1. All assemblies are supplied standard with stainless slotted washer and fasteners, with galvanized hardware on span wire clamps. Stainless upgrade available.
2. See Reference Section page v for available paint colors.

Aluminum 2-Way, 3-Way & 4-Way Span Wire Hanger Assemblies

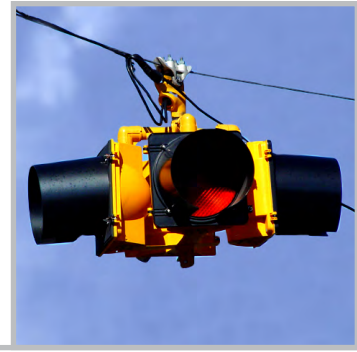
Pelco's Span Wire mountings are available in aluminum or iron with 1-1/2" NPS or tri-stud fittings. Balance adjusters provide additional adjustment capabilities, while tether assemblies may be used to anchor the bottom of signals in windy applications.



<div style="display: flex; justify-content: space-around;"> <div style="text-align: center;"> ①  </div> <div style="text-align: center;"> ②  </div> <div style="text-align: center;"> ③  </div> </div>	<div style="display: flex; justify-content: space-between; margin-bottom: 5px;"> Bushing Stainless Upgrade Coating </div> <div style="display: flex; justify-content: space-between; margin-bottom: 10px;"> ① SE-3019- <input type="text"/> - <input type="text"/> - <input type="text"/> </div> <div style="display: flex; justify-content: space-between; margin-bottom: 10px;"> ② SE-3272- <input type="text"/> - <input type="text"/> - <input type="text"/> </div> <div style="display: flex; justify-content: space-between;"> ③ SE-3274- <input type="text"/> - <input type="text"/> - <input type="text"/> </div>	<p>1-1/2" NPS Span Wire Hanger</p> <p>w/ Iron Balance Adjuster</p> <p>w/ PAL Balance Adjuster</p>
<div style="display: flex; justify-content: space-between;"> Blank=None Blank=Galv PNC=Process </div> <div style="display: flex; justify-content: space-between;"> SB=Stainless SS=Stainless No Color </div> <div style="display: flex; justify-content: space-between;"> Bushing P__=Paint </div>		

Note: For use with upper and lower arm assemblies below.
Stainless upgrade includes stainless steel fasteners and pins on span wire clamp.

Upper & Lower Arm Assy, 2-Way 16-1/2" CTC, Alum

SE-3020
Upper Arm Assy

SE-3022
Lower Arm Assy



SE-3038 -

Coating

PNC=Process No Color

P__=Paint

Upper & Lower Arm Assy, 3-Way 16-1/2" CTC, Alum

SE-3023
Upper Arm Assy

SE-3024
Lower Arm Assy



SE-3039 -

Coating

PNC=Process No Color

P__=Paint

Upper & Lower Arm Assy, 4-Way 16-1/2" CTC, Alum

SE-3025
Upper Arm Assy

SE-3026
Lower Arm Assy



SE-3040 -

Coating

PNC=Process No Color

P__=Paint

Note: 1. All assemblies are supplied standard with stainless slotted washer and fasteners, with galvanized hardware on span wire clamps. Stainless upgrade available.
2. See Reference Section page v for available paint colors.



Aluminum 2-Way, 3-Way & 4-Way Span Wire Hanger Assemblies

Pelco's Span Wire mountings are available in aluminum or iron with 1-1/2" NPS or tri-stud fittings. Balance adjusters provide additional adjustment capabilities, while tether assemblies may be used to anchor the bottom of signals in windy applications.

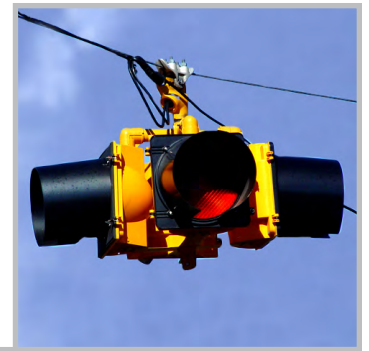

- | | |
|-------------------------------|--|
| <p>① </p> <p>② </p> <p>③ </p> | <p>① SE-5063- <input type="text"/> - <input type="text"/> - <input type="text"/> Tri-Stud Span Wire Hanger</p> <p>② SE-5088- <input type="text"/> - <input type="text"/> - <input type="text"/> w/ Iron Balance Adjuster</p> <p>③ SE-5163- <input type="text"/> - <input type="text"/> - <input type="text"/> w/ PAL Balance Adjuster</p> |
| | <p>Bushing Stainless Upgrade Coating</p> <p>Blank=None Blank=Galv PNC=Process</p> <p>SB=Stainless SS=Stainless No Color</p> <p> Bushing P__=Paint</p> |

Note: For use with upper and lower arm assemblies below.

Stainless upgrade includes stainless steel fasteners and pins on span wire clamp.

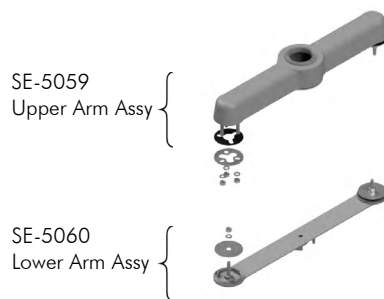

Upper & Lower Arm Assy, 2-Way 17" CTC, Cast Tri-Stud, Alum

SE-5061 -

Coating

PNC=Process No Color

P__=Paint

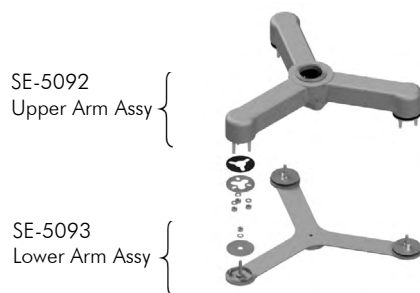

Upper & Lower Arm Assy, 3-Way 17" CTC, Cast Tri-Stud, Alum

SE-5094 -

Coating

PNC=Process No Color

P__=Paint

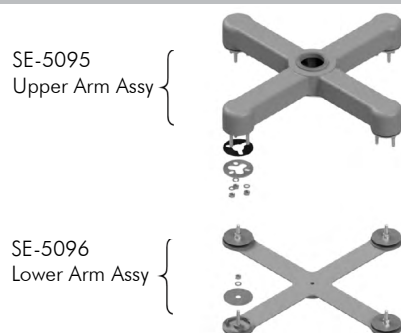

Upper & Lower Arm Assy, 4-Way 17" CTC, Cast Tri-Stud, Alum

SE-5097 -

Coating

PNC=Process No Color

P__=Paint

Note: 1. All assemblies are supplied standard with stainless slotted washer and fasteners, with galvanized hardware on span wire clamps. Stainless upgrade available.
2. See Reference Section page v for available paint colors.

Aluminum 5-Section Cluster Span Wire Hanger Assemblies

Pelco's Span Wire mountings are available in aluminum or iron with 1-1/2" NPS or tri-stud fittings. Balance adjusters provide additional adjustment capabilities, while tether assemblies may be used to anchor the bottom of signals in windy applications.

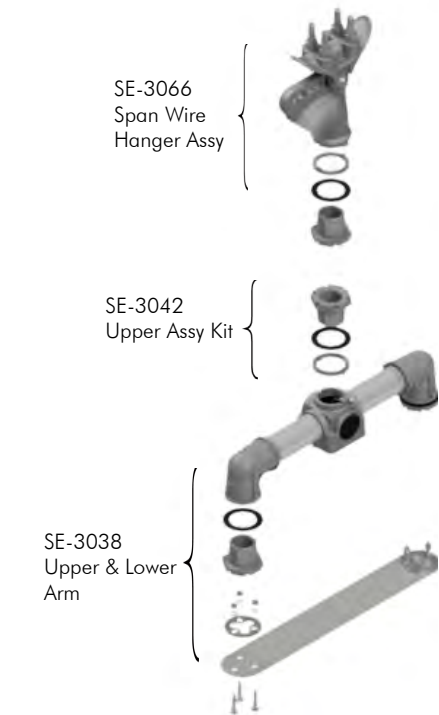

Cluster Assy, 5-Section 16-1/2" CTC, Cast Nipple, Alum

SE-3120

Bushing

Blank=None

SS=Stainless

Bushing

-

Stainless Upgrade

Blank=Galv

SS=Stainless

-

Coating

PNC=Process No Color

P__=Paint

Note:
Stainless upgrade includes stainless steel fasteners and pins on span wire clamp.



Cluster Assy, 5-Section 16-1/2" CTC, Cast Nipple, Alum

SE-3137

Bushing

Blank=None

SS=Stainless

Bushing

-

Stainless Upgrade

Blank=Galv

SS=Stainless

-

Coating

PNC=Process No Color

P__=Paint

Note:
Stainless upgrade includes stainless steel fasteners and pins on span wire clamp.



FREE-SWINGING



Note: 1. All assemblies are supplied standard with stainless slotted washer and fasteners, with galvanized hardware on span wire clamps. Stainless upgrade available.
2. See Reference Section page v for available paint colors.



Aluminum 5-Section Cluster Span Wire Hanger Assemblies

Pelco's Span Wire mountings are available in aluminum or iron with 1-1/2" NPS or tri-stud fittings. Balance adjusters provide additional adjustment capabilities, while tether assemblies may be used to anchor the bottom of signals in windy applications.

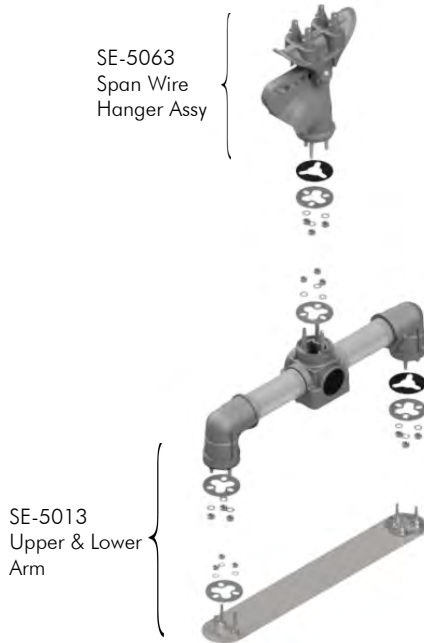
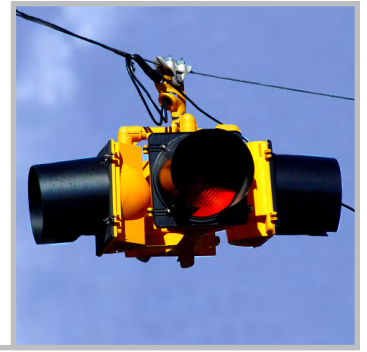

Cluster Assy, 5-Section 16-1/2" CTC, Tri-Stud, Alum

SE-5166 - - -
 Bushing Stainless Upgrade Coating
 Blank=None Blank=Galv PNC=Process No Color
 SS=Stainless SS=Stainless P__=Paint
 Bushing

Note:
Stainless upgrade includes stainless steel fasteners and pins on span wire clamp.

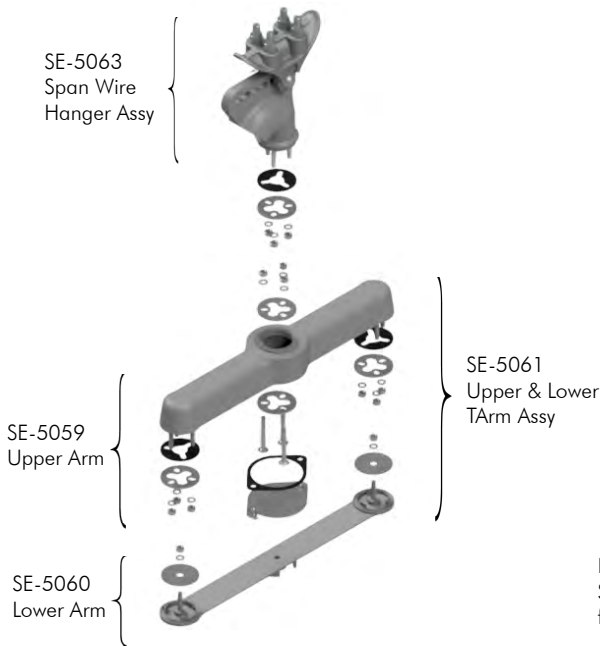

Cluster Assy, 5-Section 17" CTC, Tri-Stud, Alum

SE-5165 - - -
 Bushing Stainless Upgrade Coating
 Blank=None Blank=Galv PNC=Process No Color
 SS=Stainless SS=Stainless P__=Paint
 Bushing

Note:
Stainless upgrade includes stainless steel fasteners and pins on span wire clamp.



Note: 1. All assemblies are supplied standard with stainless slotted washer and fasteners, with galvanized hardware on span wire clamps. Stainless upgrade available.
 2. See Reference Section page v for available paint colors.

12 Circuit Disconnect Hanger Assemblies

Pelco's Disconnect Hangers are available in 12-circuit and 18-circuit with 1-1/2" NPS threaded or slip top and 1-1/2" NPS threaded or tri-stud bottom hubs.

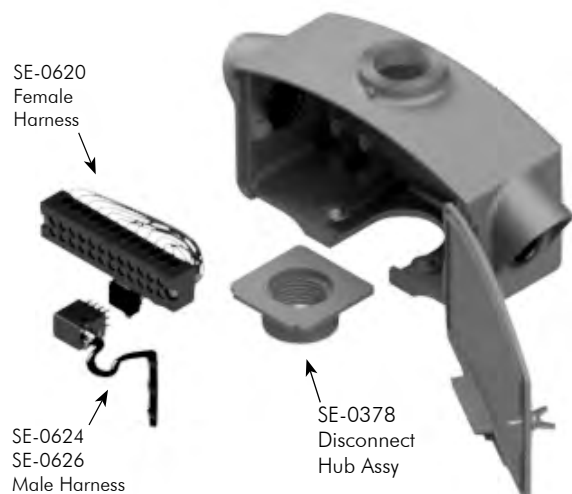

Disconnect Hanger, 12-Circuit 1-1/2" NPS Top & Bottom Hub w/ 4' Harness, Alum

SE-3073 -

Coating

PNC=Process No Color
P__=Paint

Disconnect Hanger, 12-Circuit 1-1/2" NPS Top & Bottom Hub w/ 7' Harness, Alum

SE-3195 -

Coating

PNC=Process No Color
P__=Paint

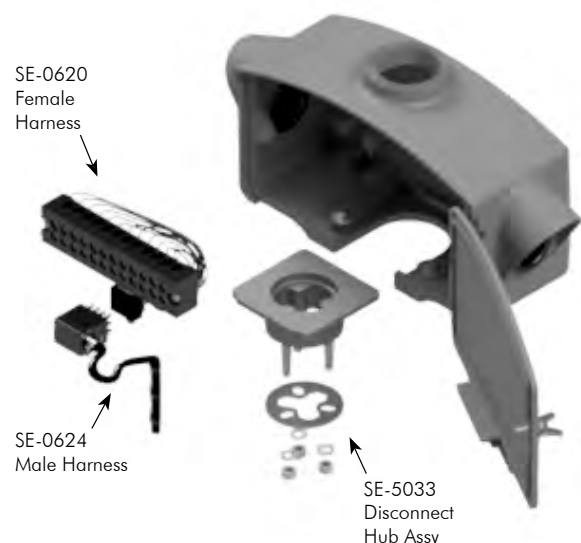

Disconnect Hanger, 12-Circuit 2" Slip Top & Tri-Stud Bottom Hub w/ 4' Harness, Alum

SE-5031 -

Coating

PNC=Process No Color
P__=Paint

- Note: 1. All harnesses come with 18 AWG wire pre-tinned and numbered on 3" centers.
2. All assemblies are supplied standard with stainless steel slotted washers and fasteners.
3. See Reference Section page v for available paint colors.



FREE-SWINGING



18 Circuit Disconnect Hanger Assemblies

Pelco's Disconnect Hangers are available in 12-circuit and 18-circuit with 1-1/2" NPS threaded or slip top and 1-1/2" NPS threaded or tri-stud bottom hubs.

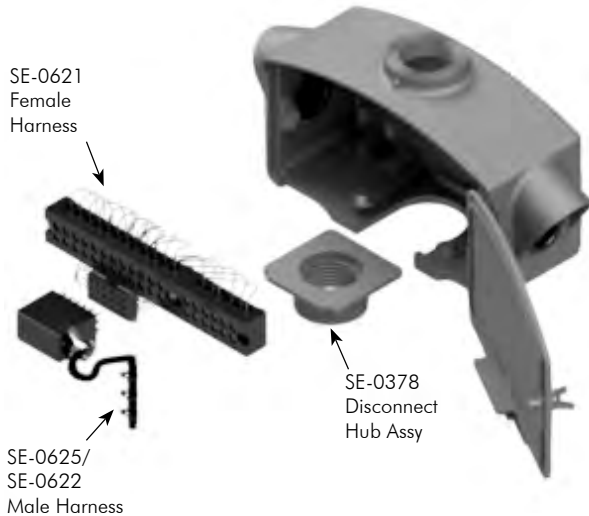
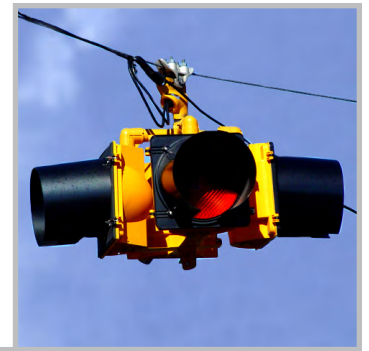

Disconnect Hanger, 18-Circuit 1-1/2" NPS Top & Bottom Hub w/ 4' Harness, Alum

SE-3077 -
Coating
PNC=Process No Color
P__=Paint

Disconnect Hanger, 18-Circuit 1-1/2" NPS Top & Bottom Hub w/ 7' Harness

SE-3196 -
Coating
PNC=Process No Color
P__=Paint



Disconnect Hanger, 18-Circuit 2" Slip Top & Tri-Stud Bottom Hub w/ 4' Harness, Alum

SE-5032 -
Coating
PNC=Process No Color
P__=Paint

- Note: 1. All harnesses come with 18 AWG wire pre-tinned and numbered on 3" centers.
2. All assemblies are supplied standard with stainless steel slotted washers and fasteners.
3. See Reference Section page v for available paint colors.

Span Wire Terminal Compartment

Pelco's Disconnect Hangers are available in 12-circuit and 18-circuit with 1-1/2" NPS threaded or slip top and 1-1/2" NPS threaded or tri-stud bottom hubs.

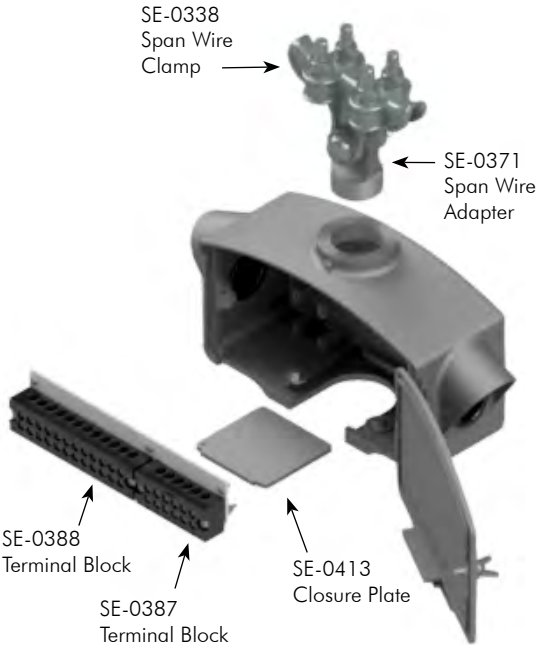

Span Wire Terminal Compartment, 18-Circuit w/ Iron Hanger Assembly, Alum

SE-3092 - -
Blank=Galv PNC=Process No Color
SS=Stainless P__=Paint

Note:
Stainless upgrade includes stainless steel fasteners and pins on span wire clamp.

Cable Clamp Kit, 2-Cable, Alum



SE-4201 -
Coating
PNC=Process No Color
P__=Paint

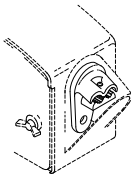

FREE-SWINGING



Note: 1. All assemblies are supplied standard with stainless slotted washer and fasteners, with galvanized hardware on span wire clamps. Stainless upgrade available.
2. See Reference Section page v for available paint colors.



Hanger Assemblies

Various hanger assemblies are available for mounting Disconnects. Assemblies are available with or without span wire clamps, balance adjusters, extenders, and tethers, fitting any specific requirement.

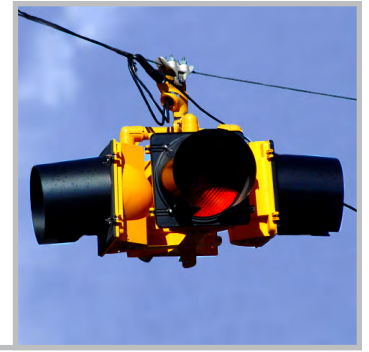

Hanger Assy, Span Wire Adapter, 1-1/2" NPS, Alum



SE-5215 -

Bushing	-	Stainless Upgrade	-	Coating
<input type="text"/>	-	<input type="text"/>	-	<input type="text"/>
Blank=None		Blank=Galv		PNC=Process No Color
SS=Stainless		SS=Stainless		P__=Paint
Bushing				

Note:
Stainless upgrade includes stainless steel fasteners and pins on span wire clamp.

Hanger Assy, Span Wire, Tri-Stud Balance Adjuster, Alum



SE-5216 -

Bushing	-	Stainless Upgrade	-	Coating
<input type="text"/>	-	<input type="text"/>	-	<input type="text"/>
Blank=None		Blank=Galv		PNC=Process No Color
SS=Stainless		SS=Stainless		P__=Paint
Bushing				

Note:
Stainless upgrade includes stainless steel fasteners and pins on span wire clamp.

Balance Assy, Tri-Stud, 3/4" Width, Alum

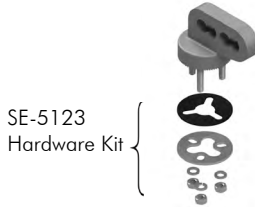

SE-5034 -

Bushing	-	Coating
<input type="text"/>	-	<input type="text"/>
Blank=None		PNC=Process No Color
SS=Stainless		P__=Paint
Bushing		

Hanger Assy, Span Wire, Tri-Stud Connector, Alum



SE-5217 -

Bushing	-	Stainless Upgrade	-	Coating
<input type="text"/>	-	<input type="text"/>	-	<input type="text"/>
Blank=None		Blank=Galv		PNC=Process No Color
SS=Stainless		SS=Stainless		P__=Paint
Bushing				

Note:
Stainless upgrade includes stainless steel fasteners and pins on span wire clamp.

Hanger Assy, Tri-Stud, 1/2" Width, Alum

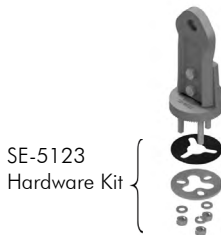

SE-5036 -

Bushing	-	Coating
<input type="text"/>	-	<input type="text"/>
Blank=None		PNC=Process No Color
SS=Stainless		P__=Paint
Bushing		

Note: 1. All assemblies are supplied standard with stainless slotted washer and fasteners, with galvanized hardware on span wire clamps. Stainless upgrade available.
2. See Reference Section page v for available paint colors.

Hanger Assemblies

Various hanger assemblies are available for mounting Disconnects. Assemblies are available with or without span wire clamps, balance adjusters, extenders, and tethers, fitting any specific requirement.

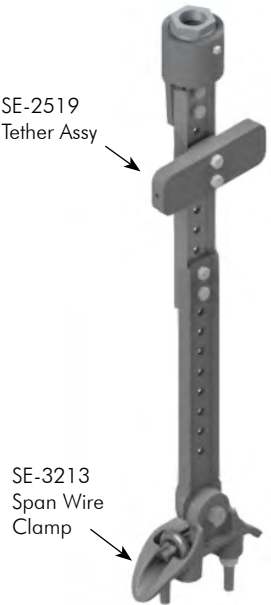

Hanger Assy, Opticom Preemption, 1" NPT w/ Span Wire Clamp & Tether, Alum

SE-3333

Extender

Blank=None
11=11" Extender
19=19" Extender
40=40" Extender
72=72" Extender

-

Stainless Upgrade

Blank=Galv
SS=Stainless

-

Coating

PNC=Process No Color
P__=Paint

Note:
Stainless upgrade includes stainless steel fasteners and pins on span wire clamp.

FREE-SWINGING



Note: 1. All assemblies are supplied standard with stainless slotted washer and fasteners, with galvanized hardware on span wire clamps. Stainless upgrade available.
2. See Reference Section page v for available paint colors.



Hanger Assemblies

Various hanger assemblies are available for mounting Disconnects. Assemblies are available with or without span wire clamps, balance adjusters, extenders, and tethers, fitting any specific requirement.

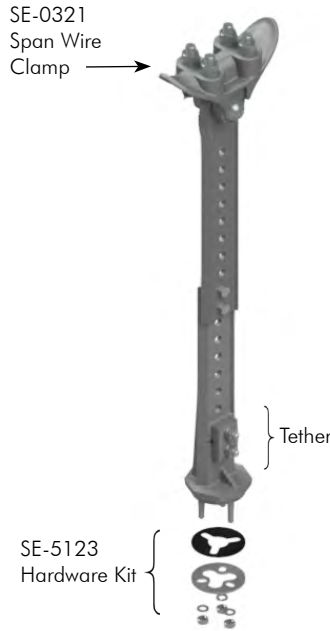
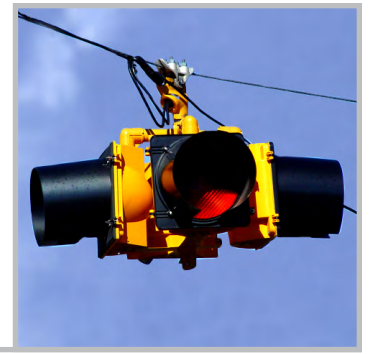

Hanger Assy, Tri-Stud Adjustable Span Wire Clamp & Tether, Alum

SE-5118 - - -
 Bushing Stainless Upgrade Coating
 Blank=None Blank=Galv PNC=Process No Color
 SS=Stainless SS=Stainless P__=Paint
 Bushing

Note:
Stainless upgrade includes stainless steel fasteners and pins on span wire clamp.

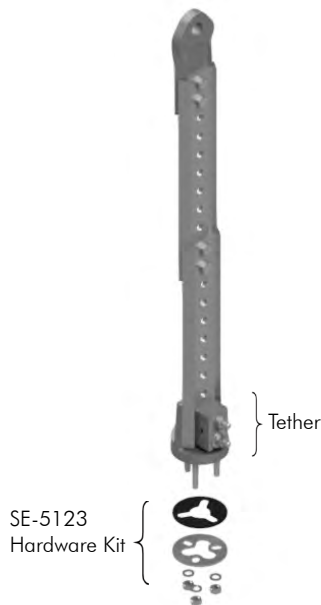

Hanger Assy, Tri-Stud Adjustable Tether, Alum

SE-5055 - -
 Bushing Coating
 Blank=None PNC=Process No Color
 SS=Stainless P__=Paint
 Bushing

Note:
Stainless upgrade includes stainless steel fasteners and pins on span wire clamp.

Note: 1. All assemblies are supplied standard with stainless slotted washer and fasteners, with galvanized hardware on span wire clamps. Stainless upgrade available.
 2. See Reference Section page v for available paint colors.

Aluminum Horizontal Span Wire Assemblies

Horizontal assemblies are available with aluminum or iron span wire clamps, wire outlet body, and CGB option for up to a 5-section signal.

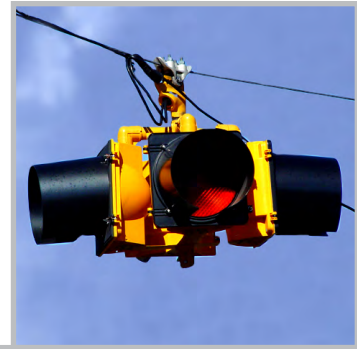

SE-0338
Iron Span Wire
Clamp

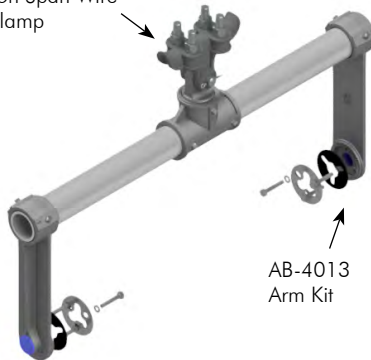

AB-4013
Arm Kit

Horizontal Span Wire Assy w/ Slip Tee, Iron Clamp, Alum

Signal Section	CGB	Stainless Upgrade	Coating
AB-0127 - <input type="text"/>	- <input type="text"/>	- <input type="text"/>	- <input type="text"/>
1=1 Sec	Blank=None	Blank=Galv	PNC=Process No Color
2=2 Sec	1=0.55"-0.65" Wire	SS=Stainless	P__=Paint
3=3 Sec	2=0.56"-0.65" Wire		
4=4 Sec			
5=5 Sec			

Note:
Stainless upgrade includes stainless steel fasteners and pins on span wire clamp.



SE-0338
Iron Span Wire
Clamp

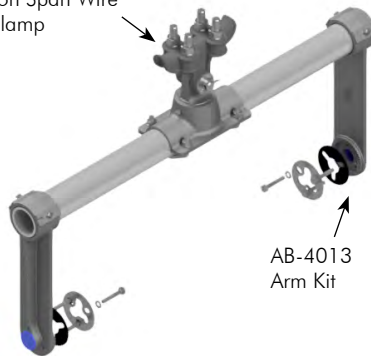

AB-4013
Arm Kit

Horizontal Span Wire Assy w/ Tube Saddle, Iron Clamp, Alum

Signal Section	CGB	Stainless Upgrade	Coating
AB-0123 - <input type="text"/>	- <input type="text"/>	- <input type="text"/>	- <input type="text"/>
1=1 Sec	Blank=None	Blank=Galv	PNC=Process No Color
2=2 Sec	1=0.55"-0.65" Wire	SS=Stainless	P__=Paint
3=3 Sec	2=0.56"-0.65" Wire		
4=4 Sec			
5=5 Sec			

Note:
Stainless upgrade includes stainless steel fasteners and pins on span wire clamp.



FREE-SWINGING



Note: 1. All assemblies are supplied standard with stainless slotted washer and fasteners, with galvanized hardware on span wire clamps. Stainless upgrade available.
2. See Reference Section page v for available paint colors.



Aluminum Horizontal Span Wire Assemblies

Horizontal assemblies are available with aluminum or iron span wire clamps, wire outlet body, and CGB option for up to a 5-section signal.

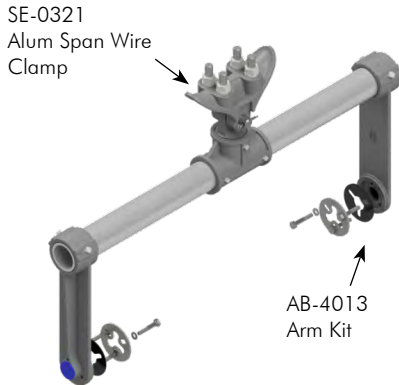

Horizontal Span Wire Assy w/ Slip Tee, Alum Clamp, Alum

Signal Section	CGB	Stainless Upgrade	Coating
AB-0126 - <input type="text"/>	- <input type="text"/>	- <input type="text"/>	- <input type="text"/>
1=1 Sec	Blank=None	Blank=Galv	PNC=Process No Color
2=2 Sec	1=0.55"-0.65" Wire	SS=Stainless	P__=Paint
3=3 Sec	2=0.56"-0.65" Wire		
4=4 Sec			
5=5 Sec			

Note: Stainless upgrade includes stainless steel fasteners and pins on span wire clamp.

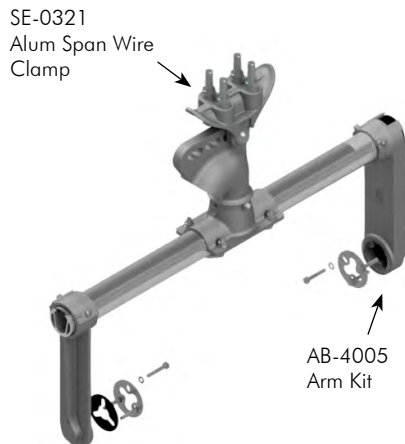

Horizontal Span Wire Assy w/ Wire Outlet Body, Alum Clamp, Alum

Signal Section	Bushing	Stainless Upgrade	Coating
AB-0122 - <input type="text"/>	- <input type="text"/>	- <input type="text"/>	- <input type="text"/>
1=1 Sec	Blank=None	Blank=Galv	PNC=Process No Color
2=2 Sec	SS=Stainless	SS=Stainless	P__=Paint
3=3 Sec	Bushing		
4=4 Sec			
5=5 Sec			

Note: Stainless upgrade includes stainless steel fasteners and pins on span wire clamp.



Note: 1. All assemblies are supplied standard with stainless slotted washer and fasteners, with galvanized hardware on span wire clamps. Stainless upgrade available.
2. See Reference Section page v for available paint colors.



This page is intentionally left blank.

Iron 1-Way Hanger Assemblies

Pelco's Span Wire mountings are available in aluminum or iron with 1-1/2" NPS or tri-stud fittings. Balance adjusters provide additional adjustment capabilities, while tether assemblies may be used to anchor the bottom of signals in windy applications.



Hanger Assy, Tri-Stud, Iron

SE-5090 - Coating
P__=Paint

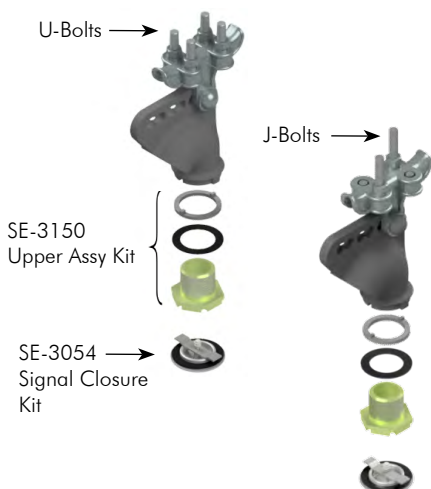

Span Wire Hanger Assy, Iron w/ Signal Closure Kit U-Bolts

SE-3139 - Stainless Upgrade - Coating
Blank=Galv SS=Stainless P__=Paint

Note:
Stainless upgrade includes stainless steel fasteners and pins on span wire clamp.

Span Wire Hanger Assy, Iron w/ Signal Closure Kit J-Bolts

SE-3250 - Stainless Upgrade - Coating
Blank=Galv SS=Stainless P__=Paint

Note:
Stainless upgrade includes stainless steel fasteners and pins on span wire clamp.

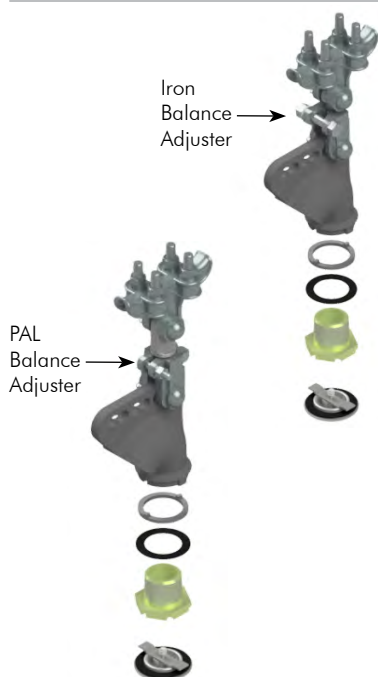

Span Wire Hanger Assy, Iron w/ Signal Closure Kit Iron Balance Adjuster

SE-3151 - Stainless Upgrade - Coating
Blank=Galv SS=Stainless P__=Paint

Note:
Stainless upgrade includes stainless steel fasteners and pins on span wire clamp.

Span Wire Hanger Assy, Iron w/ Signal Closure Kit PAL Balance Adjuster

SE-3277 - Stainless Upgrade - Coating
Blank=Galv SS=Stainless P__=Paint

Note:
Stainless upgrade includes stainless steel fasteners and pins on span wire clamp.

Note: 1. All assemblies are supplied standard with stainless slotted washer and fasteners, with galvanized hardware on span wire clamps. Stainless upgrade available.
2. See Reference Section for available paint colors.

Iron 2-Way, 3-Way & 4-Way Span Wire Hanger Assemblies

Pelco's Span Wire mountings are available in aluminum or iron with 1-1/2" NPS or tri-stud fittings. Balance adjusters provide additional adjustment capabilities, while tether assemblies may be used to anchor the bottom of signals in windy applications.

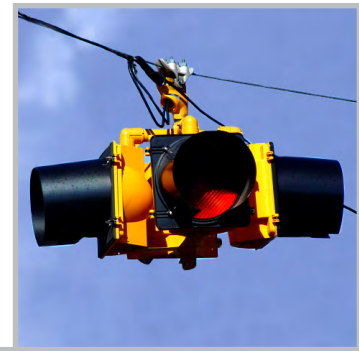

Stainless Upgrade Coating

① SE-3070- - **1-1/2" NPS Span Wire Hanger**

② SE-3273- - **w/ Iron Balance Adjuster**

③ SE-3275- - **w/ PAL Balance Adjuster**

Blank=Galv P__=Paint
SS=Stainless

Note: For use with upper and lower arm assemblies below.
Stainless upgrade includes stainless steel fasteners and pins on span wire clamp.

Upper & Lower Arm Assy, 2-Way 16-1/2" CTC Iron

SE-3154 -

Coating
P__=Paint

Upper & Lower Arm Assy, 3-Way 16-1/2" CTC Iron

SE-3156 -

Coating
P__=Paint

Upper & Lower Arm Assy, 4-Way 16-1/2" CTC Iron

SE-3158 -

Coating
P__=Paint

Note: 1. All assemblies are supplied standard with stainless slotted washer and fasteners, with galvanized hardware on span wire clamps. Stainless upgrade available.
2. See Reference Section page v for available paint colors.



Iron 5-Section Cluster Span Wire Hanger Assemblies

Pelco's Span Wire mountings are available in aluminum or iron with 1-1/2" NPS or tri-stud fittings. Balance adjusters provide additional adjustment capabilities, while tether assemblies may be used to anchor the bottom of signals in windy applications.

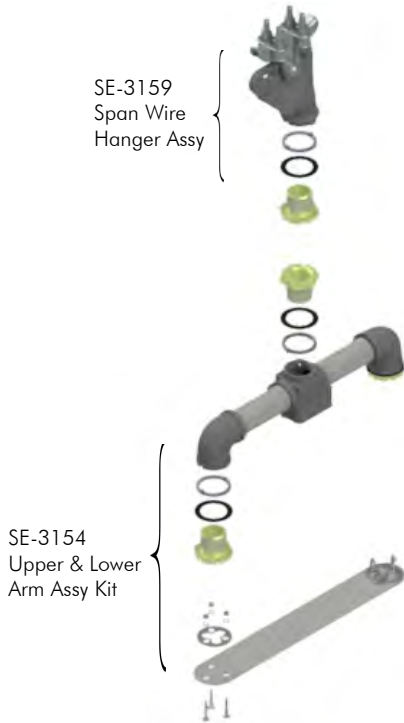
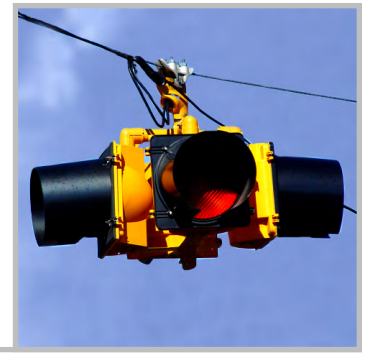

Cluster Assy, 5-Section 16-1/2" CTC Iron

SE-3160 -

Stainless Upgrade
Blank=Galv
SS=Stainless

 -

Coating
P__=Paint



Note:
Stainless upgrade includes stainless steel fasteners and pins on span wire clamp.



Cluster Assy, 5-Section 16-1/2" CTC Iron

SE-3161 -

Stainless Upgrade
Blank=Galv
SS=Stainless

 -

Coating
P__=Paint



Note:
Stainless upgrade includes stainless steel fasteners and pins on span wire clamp.

- Note: 1. All assemblies are supplied standard with stainless slotted washer and fasteners, with galvanized hardware on span wire clamps. Stainless upgrade available.
2. See Reference Section page v for available paint colors.

Signal Accessories

Pelco offers various accessories for span wire mounted signs and signals. See Section T14 Components for additional products available.



Lower Arm Assy, 2-Way, 16-1/2" CTC, Steel

SE-3162 - Coating
P__=Paint



Lower Arm Assy, 3-Way, 16-1/2" CTC, Steel

SE-3163 - Coating
P__=Paint



Lower Arm Assy, 4-Way, 16-1/2" CTC, Steel

SE-3164 - Coating
P__=Paint



Tether Assembly, Extended Bottom, Alum

SE-3307 - Length - Coating
6=6" PNC=Process No Color
18=18" P__=Paint
28=28"



SE-3055-ZN1 Tether Assembly, Steel Break-Away, 1-1/2" Pipe

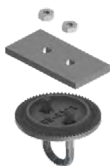

SE-3293-PNC Tether Assembly, Alum Non-Break-Away

FREE-SWINGING



Note: 1. All assemblies are supplied standard with stainless slotted washer and fasteners.
2. See Reference Section pave v for available paint colors.



Signal Accessories

Pelco offers various accessories for span wire mounted signs and signals. See Section T14 Components for additional products available.

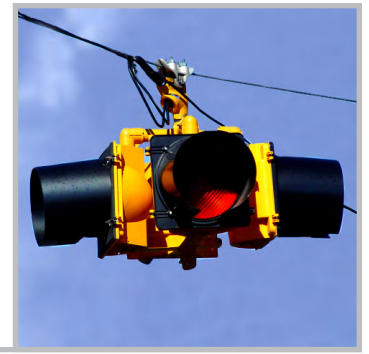

Tether Assembly, 1-1/2" Break-Away, Alum

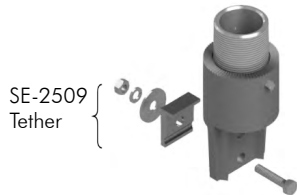

SE-5121 - Extender - Coating
Blank=No Extender PNC=Process No Color
11=11" P__=Paint
19=19"
72=72"

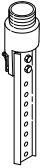

Note:
Available with or
without Extender Bar.

Tether Assembly, Tri-Stud Break-Away, Alum

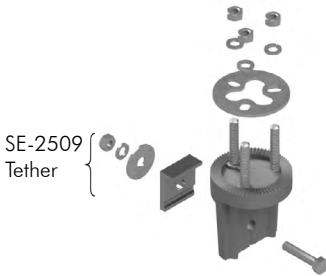

SE-5050 - Extender - Coating
Blank=No Extender PNC=Process No Color
11=11" P__=Paint
19=19"
72=72"



Note:
Available with or
without Extender Bar.

Tether Assembly, Single-Stud Break-Away, Alum

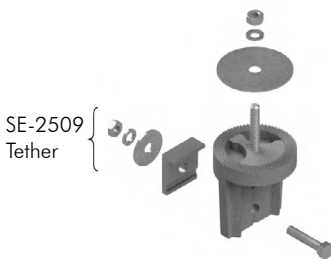

SE-5058 - Extender - Coating
Blank=No Extender PNC=Process No Color
11=11" P__=Paint
19=19"
72=72"

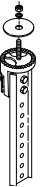

Note:
Available with or
without Extender Bar.

Extender Bar, Aluminum



SE-0507 - Length - Coating
11=11" PNC=Process No Color
19=19" P__=Paint
40=40"
72=72"

Note: 1. All assemblies are supplied standard with stainless slotted washer and fasteners.
2. See Reference Section page v for available paint colors.

Signal Accessories

Pelco offers various accessories for span wire mounted signs and signals. See Section T14 Components for additional products available.



Signal Spacer Kit w/ Aluminum Nipple, Alum Lockring, Alum Cast Nipple

SE-3306 - -
Nipple Length Coating
PNC=Process No Color
P__=Paint



Signal Spacer Kit w/ Steel Nipple, Brass Lockring, Iron Cast Nipple

SE-3302 - - -
Nipple Length Cast Nipple Coating
LCN=Long LCN=Long P__=Paint
Cast Nipple



SM-0906-ZN2 Opticom Cable Hanger, 1/2" Wire, 7/16"-14 x 3/4"-14 NPT, Iron, Zinc 2



- SE-4028-ZN1 CGB 3/4", .55"-.65" Wire Range, Zinc 1
- SE-0490-ZN1 CGB, 3/4", .625"-.75" Wire Range, Zinc 1
- SE-4216-ZN1 CGB, 1", .55"-.625" Wire Range, Zinc 1

Note: 1. All assemblies are supplied standard with stainless slotted washer and fasteners.
2. See Reference Section page v for available paint colors.



Span Wire Hardware Kits



SE-5123-SS **Tri-Stud Hardware Kit w/ Gasket, 5/16"-18
Stainless Slotted Washer & Stainless Hardware**



SE-5122-SS **Tri-Stud Hardware Kit w/o Gasket, 5/16"-18
Stainless Slotted Washer & Stainless Hardware**



SE-5125-SS **Tri-Bolt Hardware Kit w/ Gasket,
5/16"-18 x 1-1/2" Hex Hd Bolts
Stainless Slotted Washer & Stainless Hardware**



SE-5126-SS **Tri-Bolt Hardware Kit w/o Gasket,
5/16"-18 x 1-1/2" Hex Hd Bolts
Stainless Slotted Washer & Stainless Hardware**

Note: 1. All kits are supplied standard with stainless steel slotted washers and fasteners.
2. See Section T14 for additional components available.

Span Wire Hardware Kits



SE-4112-SS

**Signal to Signal Mounting Kit,
5/16"-18 x 2-1/2" Carriage Bolts
Stainless Slotted Washer & Stainless Hardware**



SE-3282-SS

**Plumbizer Hardware Kit,
5/16"-18 x 3-1/2" Carriage Bolts
Stainless Slotted Washer & Stainless Hardware**



SE-4111-SS

**Tri-Bolt Hardware Kit w/ Gasket,
1/4"-20 x 1-1/2" Hex Hd Bolts
Stainless Slotted Washer & Stainless Hardware**



SE-3227-SS

**Lower Assembly Kit,
1/4"-20 x 1-1/2" Carriage Bolts
Stainless Slotted Washer & Stainless Hardware**

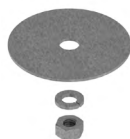

SE-5064-SS

**Single-Stud Hardware Kit, 5/16"-18
Stainless Washer & Stainless Hardware**

Note: 1. All kits are supplied standard with stainless steel slotted washers and fasteners.
2. See Section T14 for additional components available.

